

**Model: FP 400**  
**RCI Technologies**  
**Universal Fuel Purifier**

Nominal Flow: ..... 2 gal/min (7.6 lts/min)  
 In & Out Couplings:..... 1/2" NPT  
 Top Port: ..... 1/2" NPT  
 Sensor Port \*:..... 1/8" NPT  
 Drain Valve:..... Comm/Brass 1/2" Valve  
 Height:..... 12.0" Strap mount  
 Width: ..... 4.5" (114.3 mm)  
 Gross Weight: ..... 9 lbs.

\*Water Sensor and Heater are optional items.



**APPLICATIONS**

Gen Sets

Heavy Duty Diesel Trucks

Machinery

Agricultural Equipment

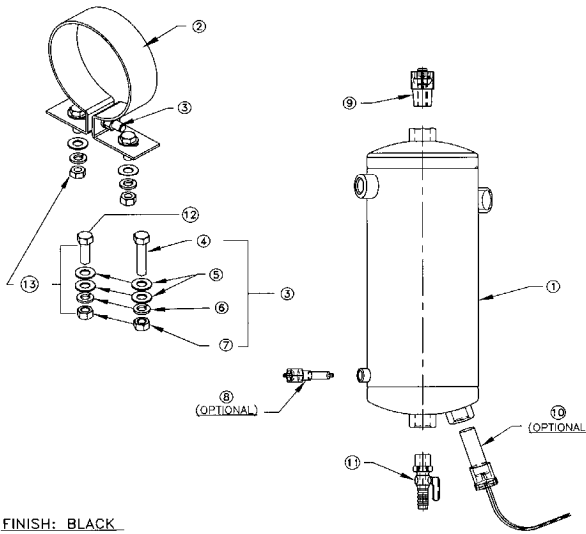

FINISH: BLACK

ITEM	PART NO.	DESCRIPTION	QTY
1	FP 400	FUEL PURIFIER	1
2	RC-002	BRACKET	2
3	RC-150	BOLT ASSY.	2
4	RC-151	BOLT 3/8 - 16 x 1.5" L.	2
5	RC-014	FLAT WASHER (SAE)	12
6	RC-015	LOCK WASHER	6
7	RC-107	NUT 3/8 -16	6
8	RC-SEN-K	RCI WATER SEN. KIT (OPTIONAL)	1
9	RC-APV	AIR PURGE VALVE	1
10	RC-HET	HEATER - 72 W 12-24 V (OPTIONAL)	1
11	RC-DVC	DRAIN VALVE COCK	1
12	RC-161	BOLT 3/8 - 16 x 1.0" L.	4
13	RC-149	BOLT ASSY.	4

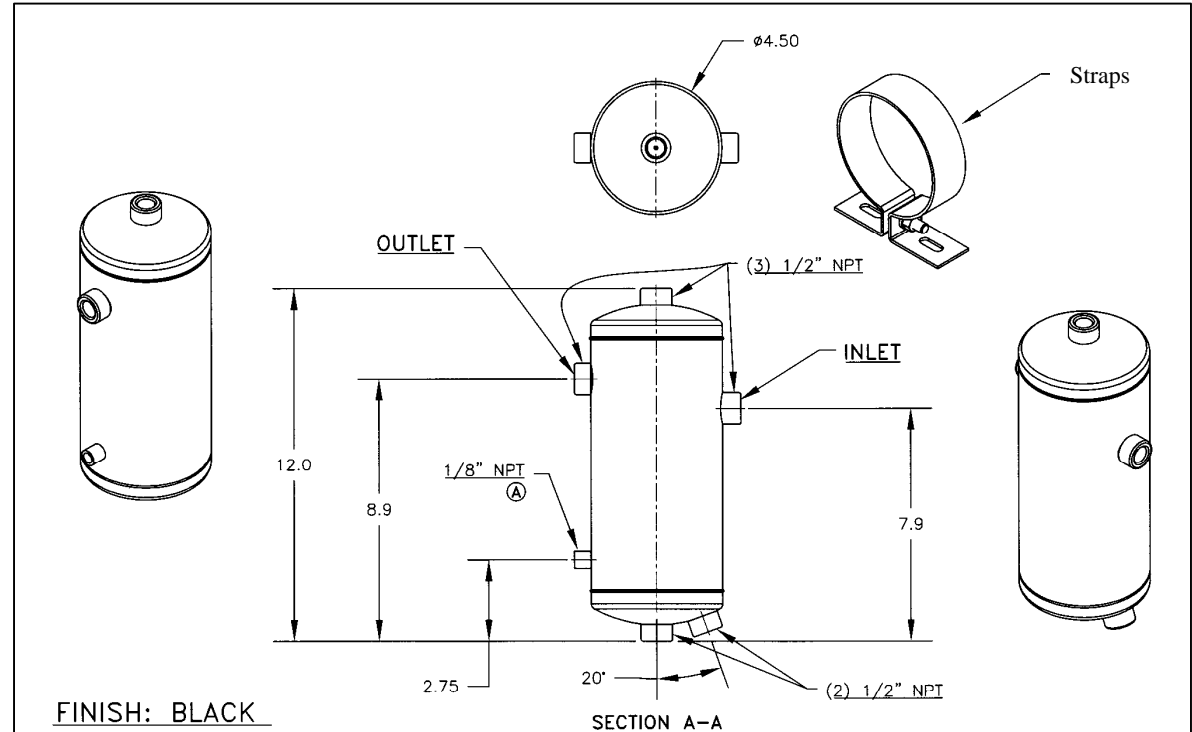

FINISH: BLACK

										NAME		DR.	DATE	
										FUEL/WATER SEPARATOR		RLT		
										RCI		CK.	SCALE	
												KJM	.25"=1"	
												MATERIAL REF:		
										8535	A	MOVED 1/8 NPT	RT	KJM
										8758		RELEASED	RT	KJM
										RCI TECHNOLOGIES		SIZE	PART NO.	
										SAN DIMAS, CALIFORNIA, U.S.A.		A	FP400	
TRANS. NO.	CHG. LET.	WAS	DATE	BY	APP.	TRANS. NO.	CHG. LET.	WAS	DATE	BY	APP.			